



# SohoLine Wall Mounting

**“Sleek & User-Friendly  
design for fast installations  
at compact locations.”**

- Space Saving
- Cost-Effective Flatpack Design
- Multiple Cable Entries

**19" /10" Wall Mounting cabinet for Small Offices &  
Home Networks**

## SIZE RANGE

7U to 12U, 520 x 400mm (19")

6U, 292 x 300mm (10")

## HIGHLIGHTS

### SPACE SAVING

- Adjustable Mounting Rails assembled to side walls
- Vertical assembly 5+2U SOHO Slimline Version
- 30 kg Load Carrying Capacity

### COST-EFFECTIVE FLATPACK DESIGN

- Saves up to 70% of Shipment and 50% of labor cost  
(due to a 5 minute assembly time)
- Quick assembly using 3 screws per edge



## DESIGN & CABLE ENTRIES

- Lockable-Removable Smoked Safety Full Glass  
Front Door
- Rubber edge sliding mechanism for top or bottom.
- Plastic and Sliding covers swappable between top  
and bottom.
- Partly removable Rear Panel.

## ACCESSORY OPTIONS

- Cooling Fans
- Extensive range of accessories

PLEASE CONTACT US FOR FURTHER OPTIONS & REQUIREMENTS

## SohoLine 19" Wall Mounting

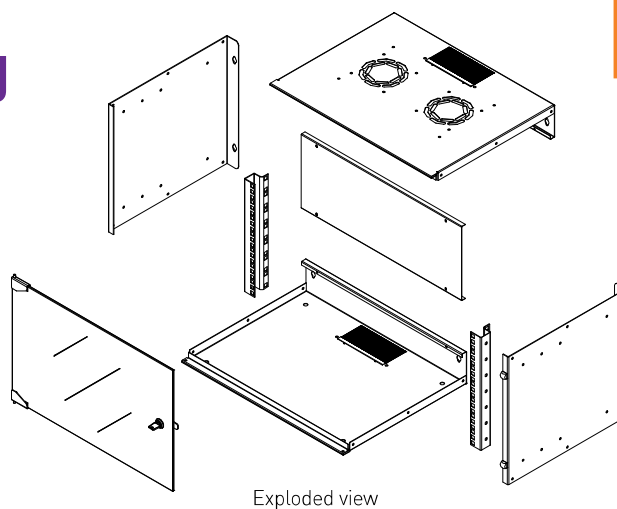

Exploded view

### SohoLine 19" Wall Mounting Cabinets Size Range

Part Number	Product definition	U size	Width: overall (mm)	Depth: overall (mm)	Height: vertical mounting profile (mm)	Height: overall (mm)
SOHO06U30	06U 520x300	6	520	300	267	319
SOHO7U40	7U 520x400	7	520	400	312	359
SOHO9U40	9U 520x400	9	520	400	401	448
SOHO12U40	12U 520x400	12	520	400	535	520

## SohoLine 10" Wall Mounting

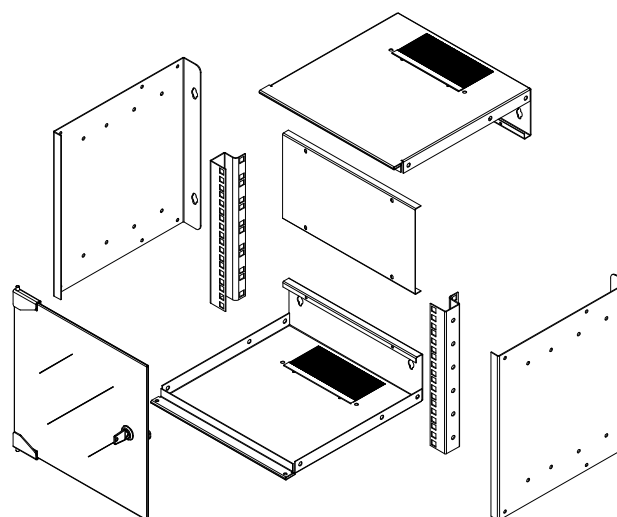

Exploded view

### SohoLine 10" Wall Mounting Cabinets Size Range

Part Number	Product definition	U size	Width: overall (mm)	Depth: overall (mm)	Height: vertical mounting profile (mm)	Height: without levelling feet (mm)	Height: overall (mm)
SOHO6U25	10" 6U wall mounting cabinet	6	292	300	267	319	334

## SohoLine 10" Accessories

Part Number	Product definition	W=292 mm D=300 mm 10"
SOHSR10	1U 10" Shelf	X
SOHORG10	1/2U 10" Cable management panel with patchcord access hole.	X
SOHORG10 KNC	1U 10" cable management panel with 3ring	X
SOHPP8P	1U patch panel unloaded RJ45 compatible	X
SOHTGP3P	1U 10" 3way power strip c/w cable and on/off switch	X

# Soho SlimLine Wall Mounting



ESTAP STAP SOHO Slimline 19" wall mounting cabinets provides an aesthetic, functional, decorative and economic solution for cabling installations. SOHO Slimline features a modular, sturdy and sleek design, ideal for;

- Offices
- Computer Aided Classes
- Schools
- Government Offices
- Hotels
- Branch Offices

## KEY FEATURES

- Easy to access
- Completely opening front door
- Lockable
- Mechanical distance holder
- Large cable openings for multi-cable entry
- Fast installation, low manpower
- Time Saving installation
- Heavy duty base plate
- Punched holes for device fixing or cable management
- 19" 5U device mounting capacity (2 vertical + 3 horizontal)
- Breakable fan holes
- Plexi-glass front window in front door
- Heavy duty hinges
- Slim depth only 140 mm
- Sturdy and strong steel construction
- High Quality Package: Shrink plastic wrapped with on high density cardboard. Styrofoam supported corners.

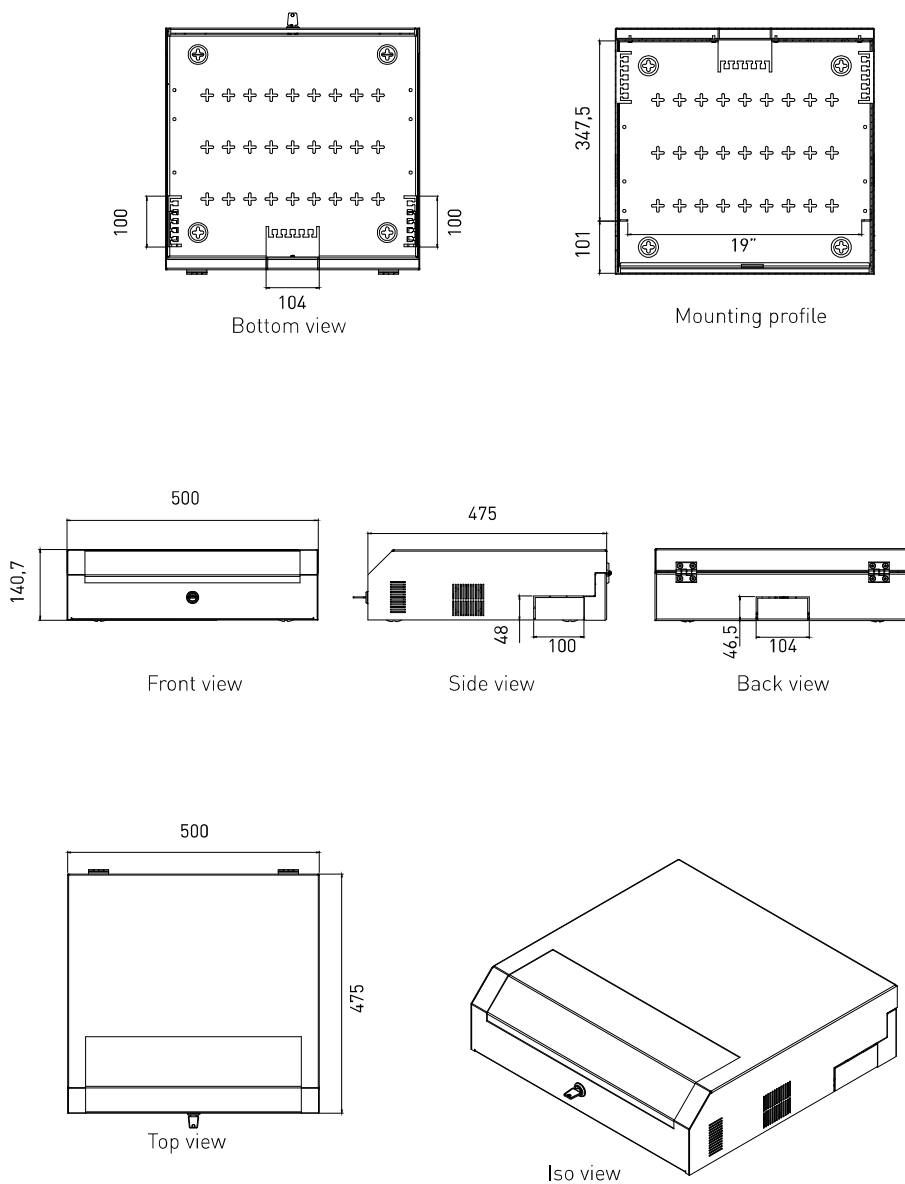

H= Enclosure height

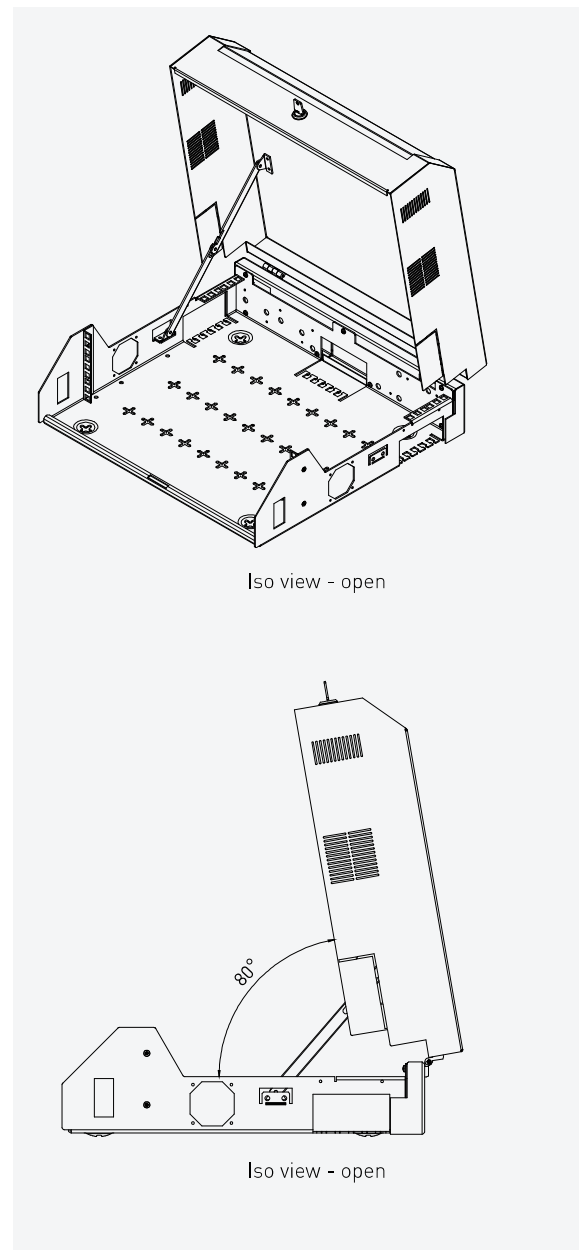

## Soho SlimLine 19" Wall Mounting Type

Part Number	Product definition (mm)	U size	Width: overall (mm)	Depth: overall (mm)	Height: vertical (mm)
SLM007	19" wall mounting cabinets 5U: 3U+2U	5	500	475	140

# Soho SlimLine Wall Mounting

## TESTS AND CERTIFICATIONS

### **Environment**

EN61587-1/4.2, IEC60068-2-1, IEC60068-2-2, IEC60068-2-30, IEC60917 and IEC60297

### **Industrial environment**

EN61587-1/4.3, IEC60068-2-42, IEC60068-2-43 and IEC60068-2-49, IEC60068-2-1, IEC60917 and IEC60297

### **Statcal mechanical structure load test**

EN61587-1 / 5.2.1, IEC60917 and IEC60297

### **Statcal mechanical structure stability**

EN61587-1 / 5.2.2, IEC60917 and IEC60297

### **Dynamic load, vibration and mechanical stroke**

EN61587-1 / 5.3.1, EN61587-1 / 5.3.3, IEC60917, IEC60297, IEC62208

### **Grounding continuity**

EN61587-1 / 6.2, IEC60917 and IEC60297

### **Fire and flame resistance**

EN61587-1 / 6.3, IEC60917 and IEC60297

### **Corrosion**

ISO9227 and ASTM B 117-85, IEC60917 and IEC60297

### **IP protection degree**

IP20 accordingly EN61587-1 / 6.4, IEC60529, IEC60917 and IEC60297

### **Transportation**

ETS300019-1-2 Class2.3

### **Storage**

ETS300019-1-1 Class1.2

### **Security**

EN60950\_LVD

## PURCHASED PRODUCT CERTIFICATION

### **Sheet steel**

DIN EN 10130 – 99 Ereğli DC- 01 6112, 7122, RoHS

### **Electrostatic powder coating**

ISO 9001, ISO 2178, ISO 2813, ISO 6272, ISO 8130-5, ISO 8130-3, RoHS

### **Fan**

ISO 9001, CE (89/336/EEC EMC, 73/23/EEC LVD), RoHS

### **Glass**

ISO 9001, EN 12150 – 1: 2000 tempered and secure

### **Fixings**

DIN 7985, DIN 965, DIN 7981, DIN 934, DIN 985, DIN 933, RoHS

### **Casters**

TS EN 12530, TS EN 12532, RoHS

### **Lock**

DIN 1743, DIN 53571, RoHS

## KEY FEATURES

Main framework must be with a structure which increases mechanical resistance and offer aesthetic appearance, manufactured with “U” shaped side panels closing on the top and bottom case for framework stability. Manufactured and tested to provide axial (x, y, z) resistance that meets EN 61587-1 / 5.2.1 and 5.2.2, and external impact resistance that meets EN 61587-1 / 5.3.3.

Bottom and upper case have a structure which increases resistance and strength of cabinet; monoblock bended top and bottom housing cases provide increased stability. Each side panel body is screwed to top and bottom cases with M5x10 screws. Cable access at top case is via a brushed access plate that blocks dust inlet.

A plastic cable entry cover plate housed at bottom case can be replaced with the brushed cable entry on top; of cables to enter from bottom.

Rear panel in standard mechanically locked with 4 screws from inside.

Side panels are non-opening screwed style, for maximum stability.

Front door is glass which is tempered, anti-static, secure and smoked glass (4 mm thickness), according to EN 12150-1:2000 standard. It can open 220 degrees, is removable and lockable Vented top panel housing with a dedicated space for ventilation, fan module system allows easy installation of max. 2 fans.

19”(inch) mounting angles for 2 ea. in front are part of the cabinets interior configuration.

The cabinet meets EN 61587-1, IEC 60917, IEC 60297 standards, RoHS compliancy, EAC and TSE certified.

Cabinets are manufactured in our factory which has ISO 9001: 2008 Quality Assurance System and our responsibility for environment with ISO 14001:2004 Environmental Management System.