



EuroLine Wall Mounting

“Cost-Effective, Compact and flexible cabling solution for limited U space requirements.”

- Compact, Aesthetic & Rigid
- Easy to Install & Use
- Optimal Cabling
- Ready to Use

19" Wall Mounting cabinet easy home & small office Networks.

HIGHLIGHTS

COMPACT, AESTHETIC & RIGID STRUCTURE

- Special folded design Monoblock body
- Main load carried by a 30x20 mm closed profile frame, welded to 1,5 mm zinc plated wall fixing bracket.
- 50 KG Load Carrying Capacity



EASY TO INSTALL

- Easy Wall Installation
- Easy handling on site by low physical weight.
- 3-side access thanks to its Lockable Removable Side Panels & Smoked Safety Glass Front Door

OPTIMAL CABLING

- Wide, brushed Top and Bottom cable entries

READY TO USE

- Pre-assembled quick and easy installation

ACCESSORY OPTIONS

- Cooling Fans,
- Additional rear Mounting Rails,
- Casters or Leveling Feet
- Extensive range of conventional accessories

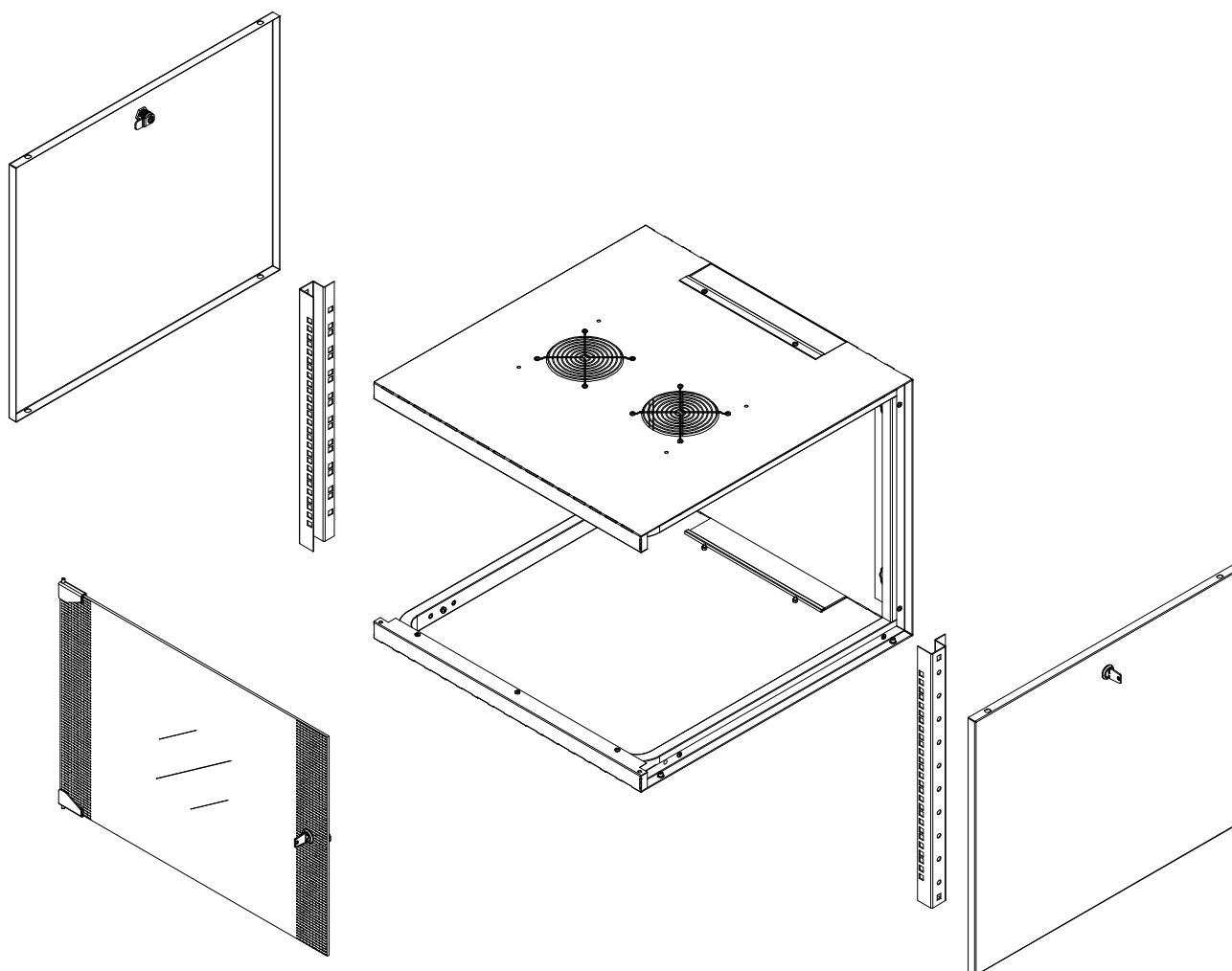

Exploded view

EuroLine Wall Mounting Cabinets Size Range

Part Number	Product definition	U size	Width: overall (mm)	Depth: overall (mm)	Height: vertical mounting profile (mm)	Height: overall (mm)
EU7U450	7U 600x450	7	600	450	395	400
EU9U450	9U 600x450	9	600	450	485	489
EU12U450	12U 600x450	12	600	450	615	622
EU16U450	16U 600x450	16	600	450	795	800
EU7U600	7U 600x600	7	600	600	395	400
EU9U600	9U 600x600	9	600	600	485	489
EU12U600	12U 600x600	12	600	600	615	622
EU16U600	16U 600x600	16	600	600	795	800

PLEASE CONTACT US FOR FURTHER OPTIONS & REQUIREMENTS

EuroLine Wall Mounting

TESTS AND CERTIFICATIONS

Environment

EN61587-1/4.2, IEC60068-2-1, IEC60068-2-2, IEC60068-2-30, IEC60917 and IEC60297

Industrial environment

EN61587-1/4.3, IEC60068-2-42, IEC60068-2-43 and IEC60068-2-49, IEC60068-2-1, IEC60917 and IEC60297

Statical mechanical structure load test

EN61587-1 / 5.2.1, IEC60917 and IEC60297

Statical mechanical structure stability

EN61587-1 / 5.2.2, IEC60917 and IEC60297

Dynamic load, vibration and mechanical stroke

EN61587-1 / 5.3.1, EN61587-1 / 5.3.3, IEC60917, IEC60297, IEC62208

Grounding continuity

EN61587-1 / 6.2, IEC60917 and IEC60297

Fire and flame resistance

EN61587-1 / 6.3, IEC60917 and IEC60297

Corrosion

ISO9227 and ASTM B 117-85, IEC60917 and IEC60297

IP protection degree

IP20 accordingly EN61587-1 / 6.4, IEC60529, IEC60917 and IEC60297

Transportation

ETS300019-1-2 Class2.3

Storage

ETS300019-1-1 Class1.2

Security

EN60950_LVD

PURCHASED PRODUCT CERTIFICATION

Sheet steel

DIN EN 10130 – 99 Ereğli DC- 01 6112, 7122, RoHS

Electrostatic powder coating

ISO 9001, ISO 2178, ISO 2813, ISO 6272, ISO 8130-5, ISO 8130-3, RoHS

Fan

ISO 9001, CE (89/336/EEC EMC, 73/23/EEC LVD), RoHS

Glass

ISO 9001, EN 12150 – 1: 2000 tempered and secure

Fixings

DIN 7985, DIN 965, DIN 7981, DIN 934, DIN 985, DIN 933, RoHS

Casters

TS EN 12530, TS EN 12532, RoHS

Lock

DIN 1743, DIN 53571, RoHS

KEY FEATURES

- Main profile (framework) has a structure which increase mechanical resistance with an aesthetic appearance. The main profile (Frame work- consisting of 30x20 mm specially folded closed profile system) provides framework stability parallel the outer cover. The framework is hidden inside the enclosure body (skin) construction, ensuring the framework is heavy duty but provides a pleasing aesthetic finish in RAL 9016 colour.

- The framework has been tested to ensure, (x, y, z) axis resistance that meets EN 61587-1 / 5.2.1 and 5.2.2 and external impact resistance that meets EN 61587-1 / 5.3.3.

- The specially folded, single piece enclosure body functions as a cover on the framework (Load carrying profile system)
A brushed cable entry housed at top and bottom case of enclosures sized 55x300 mm.

- Rear panel is a part of the single piece unique enclosure body.
Side panels have a structure that can be opened and removed with barrel type lock with key. Front doors are made using a lateral framed glass structure which is tempered, anti-static, secure and smoked glass (4 mm thickness) with decorative silk screen pattern, according to EN 12150-1:2000 standard.

- Front door can be opened to 210 degrees, is removable and lockable with a barrel type locking unit.

- Punched top panel housing with a dedicated space for ventilation, fan module system allows easy installation of max. 2 fans.

19"(inch) mounting angles for 2 ea. in front are part of cabinet interior configuration.

- Levelling feet or caster group is optional.

- The cabinet meets EN 61587-1, IEC 60917, IEC 60297 standards, RoHS compliancy, EAC and TSE certified.

- Cabinets are manufactured in our factory which has ISO 9001: 2008 Quality Assurance System and our responsibility for environment with ISO 14001:2004 Environmental Management System.

STANDARD PRODUCT

Standard colour

Black: RAL 9005, Gray: RAL 7035

IP protection standard

IP20

FRONT DOOR

Shatterproof glass with left and right metal frame

Glass

4 mm full-length smoked, shatterproof, tempered, secure

Front door construction

Single door opening with barrel type lock

Front door lock

Barrel type, single point locking

Hinge system

Fixed

Door opening angle

210 degree, possible to swap one side to the other

SIDE PANEL

Solid metal, 0,8 mm. Left and right (2 ea.)

Side panel construction

Lockable, removable c/with barrel type lock

Lock

Barrel type lock unit, single point

REAR PANEL

Solid metal 0,8 mm supported with 1,5 mm wall fixing brackets welded to main load carrying unit.

Rear panel construction

Single piece unique body, part of enclosure body-monoblock

LOAD CARRYING FRAME

Solid metal 30x20 mm closed profile system

Load carrying construction

Multi folded 30x20 mm closed profile system welded to 1,5 mm wall fixing bracket. The whole load carrying frame is hidden inside the enclosure body

ENCLOSURE BODY

Solid metal, 0,8 mm

Enclosure body construction

Specially folded single piece body, to meet the design criteria.

INTERIOR PARTS

19" mounting angles

Solid metal, 1,5 mm

3 times folded as "C" profile system.

2 ea. in front.

Pre-configured as 19"

Zinc plated, passivated, 8-12 micron.

Custom number

85380000 / 85381000 / 853710990019

Packs of (ea.)

1

Shipping structure

Assembled

Mounting type

Wall mounting

Load carrying capacity (kg)

60 kg

Certification on product

TSE, EAC

Surface finish

Electrostatic powder coated c/with surface treatment , 80 +/- 5 micron paint thickness and tested according to IEC 60068-2-1,2-2, 2-30,2-42, 2-43, 2-49, 2-11

